

Campaign Goals

The ultimate goal of this campaign is to raise, over a giving period of three years (four tax years) from October 2008 through October 2012, at least \$1.5 million to begin the construction of our new Multipurpose/ Fellowship Building. Reaching the \$1.5 million represents our FAITH in GOD and this campaign. The intermediate goals along the way are stepping stones to our FAITH goal.

Campaign Goals

GENEROSITY
\$1,500,000

FAVOR
\$1,000,000

PRAISE
\$800,000

FOUNDATION
\$500,000



Multipurpose / Fellowship Building

OPENING NEW DOORS!!

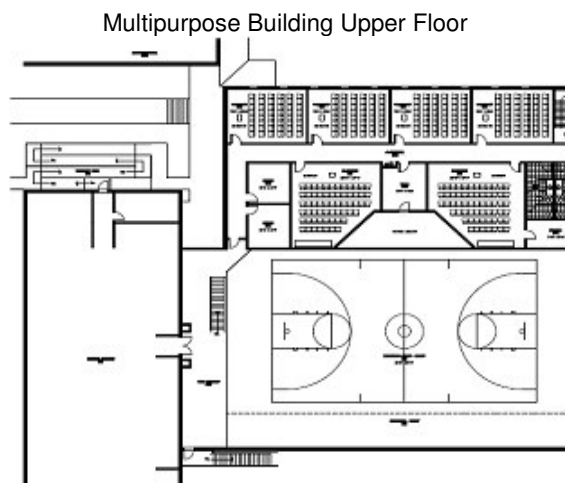

*"Opening New Doors of Opportunities
for Ministry"*

How To Make A *Lifestyle* Commitment

*"I will not offer to God
that which costs me nothing"*
2 Samuel

Rev. Wimbley Hale, Jr., Pastor

122 Watterson Street
Jonesboro, GA 30237
Phone (770) 471-7200
Fax (770) 471-7054

Email: acumc2@bellsouth.net
Website www.andrewschapel.com

S *teps to Making A* **Lifestyle Commitment**

1. Before you think about money, ask God to point out anything that is hindering your relationship with God. Consecrate your temple and rededicate yourself to God first, then you can hear what God is saying about your resources. (2 Chronicles 29:1)
2. Pray individually, and if married, as a couple. Ask God to direct you to the amount God wants you to give toward the Lifestyle Stewardship Campaign. Ask God to stretch you beyond your comfort zone so that you can see God work in an exciting new way in your life.
3. Ask yourself what amount of money:
 - You would desire to give, and
 - You could believe God to provide for you to give
4. Prayerfully write down the amount you believe God is speaking to your heart by asking yourself and discussing with your family the following questions:
 - Is this amount a worthy sacrifice in light of my (our) faith in God's ability?
 - Am I (Are we) excited about trusting God for this sacrifice, or am I (are we) being motivated by fear, pride or competition in pledging this amount?
 - Can I (we) honestly say this pledge is going to require an adjustment in my (our) lifestyle?
5. If you can answer YES to all of these questions, then you can feel comfortable about your gift amount. Otherwise, repeat steps 2 through 4 until you are comfortable with your answers in Step 4.

6. Once God gives you peace about the appropriate amount, make your pledge and resolve in your heart to follow through.
(2 Corinthians 8:11-12)

Calculating Your Commitment

Soon you will receive a Commitment Card. The back of the card contains a Giving Profile Guide that may assist you in estimating your gift to the "Opening New Doors of Opportunities for Ministry" Lifestyle Stewardship Campaign.

Please review the guide below so that you may be prayerfully prepared to make your commitment on Victory Sunday, October 26, 2008 when you receive your card.

Gift Profile Guide Three Years - Over and Above Your Current Giving Giving Period: October 2008 - October 2012 (Four Tax Years) \$1,500,000		
Total Gift Amount Given Over 3 Years	Monthly Amount for 36 Months	Weekly Amount for 156 Weeks
\$80,000	\$2,222 /Month	\$512 /week
\$75,000	\$2,083 /Month	\$480 /week
\$65,000	\$1,805 /Month	\$416 /week
\$50,000	\$1,388 /Month	\$320 /week
\$35,000	\$972 /Month	\$224 /week
\$20,000	\$556 /Month	\$129 /week
\$15,000	\$417 /Month	\$97 /week
\$12,000	\$333 /Month	\$76 /week
\$10,000	\$277 /Month	\$64 /week
\$7,000	\$194 /Month	\$44 /week
\$5,000	\$138 /Month	\$32 /week



This giving profile guide is not designed to direct your giving, but rather to represent specific gifts broken down into annual, monthly and weekly increments. Your amount may not appear on this chart.

Things You Should Know

- Lifestyle stewardship is giving that impacts our way of living.
- God measures our gift not by comparing us to others, but by our sacrifice.
- Our giving must touch the things we value to truly have meaning to God.
- Your commitment is over and above your regular tithes and offerings.
- No commitments will be received until Victory and First Fruits Sunday, November 9, 2008
- Your commitment is confidential and will not be announced.

**"According to your faith be it unto you."
Matthew 9:29**